

AMT H-Brake belt replacement

Applies to

All AMT700/800 units.

Issue/Symptoms

H-Brake belt replacements currently ship with the attaching clamps. However, the belt itself can now be replaced and the clamps can be reused.

Resolution

Follow the below procedure to replace only the belt for H-Brake belt replacements.

Tools required

- 7/16" wrench
- 7/16" socket
- #1 Phillips screwdriver
- OTC-6673 tension gauge

Parts required

Item	QTY	Part Number	Description
1	1	301324-102	BELT, H-BRAKE
2	2	301322-101	BELT CLAMP, MOLDED
3	2	301321-101	BELT CLAMP, EXTRUSION
4	4	PBTN016-050	SCREW,S/T,#8X1/2,PANHD,PHIL,BLK SHARPERIZED

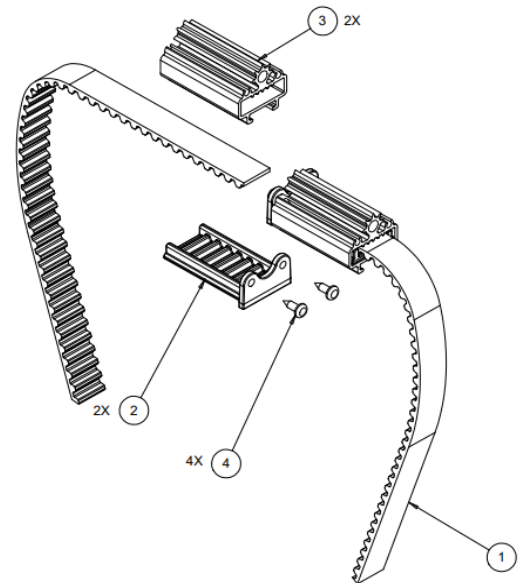

Procedure

Review entire procedure before starting.

- 1 Using a 7/16" wrench and socket, remove the H-Brake belt per the [AMT Service Manual](#).
- 2 With the belt removed, remove two screws from the molded clamp and slide it back from the extrusion clamp freeing the belt. Remove the clamp parts from the old belt.



- 3 Seat the new belt onto the teeth in the molded clamp. Leave a gap between the belt and the end of the molded clamp (**see below picture**). The extrusion clamp won't fully seat with the belt pushed to the end.



- 4 With the belt seated in the molded clamp, slide the molded clamp into the extrusion clamp and secure with two screws.



Caution: Take care when inserting the screws to not cross-thread them.

- 5 Torque the screws to 20-30 in-lbs (3.5 – 5.3 Nm).
- 6 Repeat for the other side of the belt.
- 7 Replace the belt on the unit per the [AMT Service Manual](#). Using the OTC-6673 tension gauge, tension the belt to 130 – 140 lb (59 – 63.5 kg).
- 8 Verify operation and return to service.